



Valve location unknown

Valve 
Meter 

Water Line 

All line locations are approximate

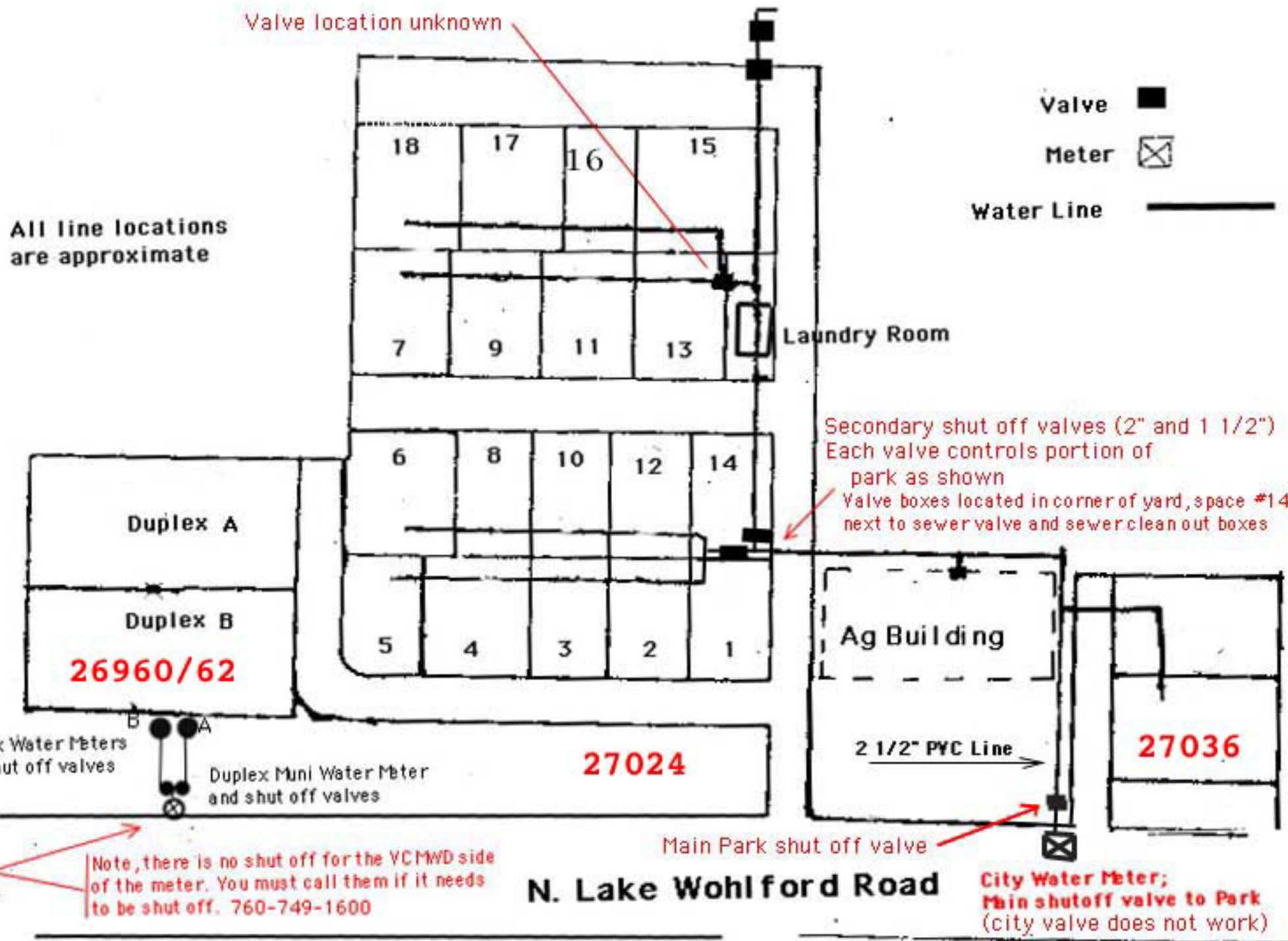

Secondary shut off valves (2" and 1 1/2")
Each valve controls portion of park as shown
Valve boxes located in corner of yard, space #14 next to sewer valve and sewer clean out boxes

Note, there is no shut off for the VCMWD side of the meter. You must call them if it needs to be shut off. 760-749-1600

City Water Meter;
Main shutoff valve to Park
(city valve does not work)

N. Lake Wohlford Road

Nov, 2010

Water Line Layout